

DYSBS Shear beam load cells

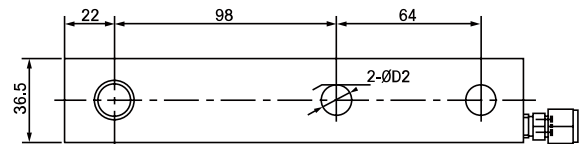
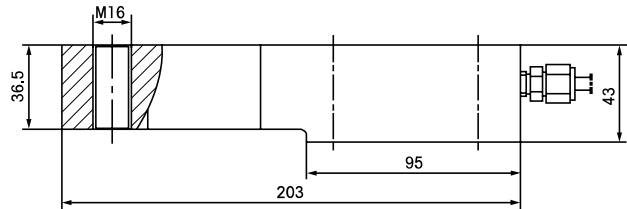

Parameters Table

Range	0-3T	Material quality	Alloy steel / stainless steel
Output sensitivity	2.0±0.02mV/V	Impedance	350Ω
Zero point output	±1%F.S.	Insulation resistance	≥5000MΩ/100VDC
Nolinear	0.03%F.S.	Service voltage	5-15V
Hysteresis	0.03%F.S.	Operating temperature range	-20-80°C
Repeatability	0.02%F.S.	Safe overload	150%
Creep (30 min)	0.02%F.S.	Extreme overload	200%
Temperature sensitivity drift	0.03%F.S./10°C	Cable line specifications	φ5x3m
Xero point temperature drift	0.03%F.S./10°C	Cable limit tension	10kg
Response frequency	10kHz	TEDS	Selectable

Range (T)	D2
0.3-2	13
3	15