

# DYQ-101 Shear beam load cells

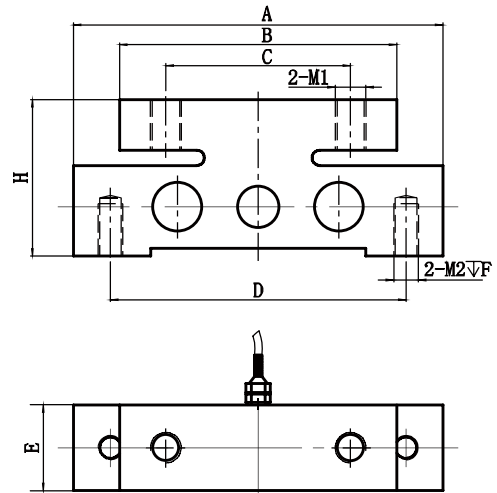

## Product Reviews

### Characteristic

It is not sensitive to the change of loading point, good anti-load performance, good inherent linearity, convenient installation, the weighing sensor is not fixed, and the center of gravity is high. It is recommended to choose the wheel spoke or column structure sensor for large scale amount.

### Application Area

- Truck Scale
- Rail Weighbridge
- Axis Weight Scale
- On The Ground Heng
- Storage Scale

Parameters Table

Range	1-30T	Material quality	Alloy Steel
Output sensitivity	1.0±0.05mV/V	Impedance	700Ω
Zero point output	±1%F.S.	Insulation resistance	≥5000MΩ/100VDC
Nolinear	0.2%F.S.	Service voltage	5-15v
Hysteresis	0.2%F.S.	Operating temperature range	-20-60°C
Repeatability	0.1F.S.	Safe overload	150%
Creep (30 min)	0.1%F.S.	Extreme overload	200%
Temperature sensitivity drift	0.03%F.S./10°C	Cable line specifications	φ5x5m
Xero point temperature drift	0.05%F.S./10°C	Cable limit tension	10kg
Response frequency	10kHz	TEDS	

Range (T)	A	B	C	D	E	H	M1	M2	F
1-5	220	140	110	186	45	85	M16	M12	20
10-20	240	180	120	192	50	93	M20	M16	30
30	240	180	120	192	56	102	M20	M16	30