

DYLY-106 S type load cells

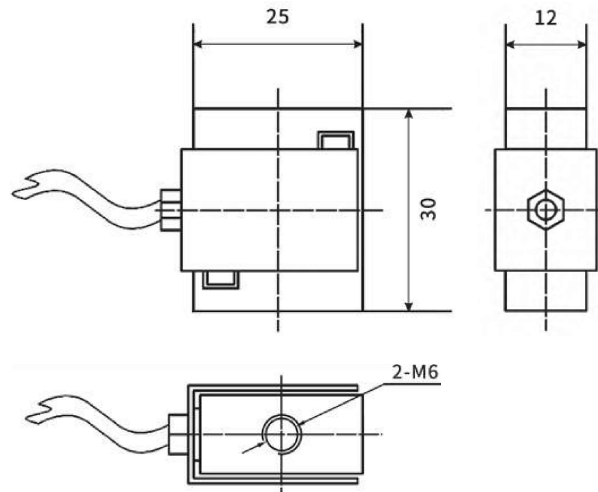

Product Reviews

Characteristic

The elastomer adopts the S-type beam-type structure. With small shape, two ends of thread design, small volume, high accuracy, easy installation, can meet the force measurement within the range of 1-100kg.

Application Area

- The car pressure
- Automated assembly
- 3C product testing
- Robot hand grip
- Keyboard hand feel degree test, etc

Parameters Table

Range	0-100kg	Material quality	Alloy Steel
Output sensitivity	1.0-2.0mV/V	Impedance	350Ω
Zero point output	±1%F.S.	Insulation resistance	≥5000MΩ/100VDC
Nolinear	0.05%F.S.	Service voltage	5-15V
Hysteresis	0.03%F.S.	Operating temperature range	-20-80°C
Repeatability	0.03%F.S.	Safe overload	150%
Creep (30 min)	0.03%F.S.	Extreme overload	200%
Temperature sensitivity drift	0.03%F.S./10°C	Cable line specifications	φ3x2m
Xero point temperature drift	0.03%F.S./10°C	Cable limit tension	10kg
Response frequency	10kHz	TEDS	

Range (kg)

0	1	2	3	5	10	20	30	50	100
---	---	---	---	---	----	----	----	----	-----