

DYLY-101 S type load cells

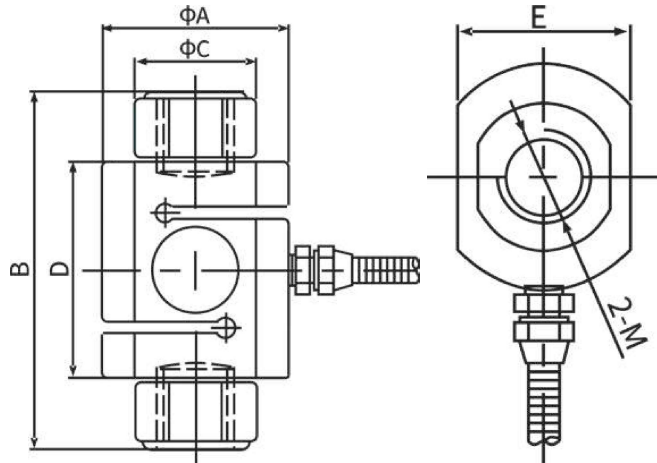

Product Reviews

Characteristic

S-type is a common force sensor shape, characterized by simple structure, light weight, convenient installation, high precision, good linearity and high stability. Such sensors are commonly used to measure both light and moderate loads.

Application Area

- Machinery manufacturing industry: such as machine tool, pressure machine, injection molding machine, etc.
- Petrochemical industry: such as petroleum, chemical industry, coal gas, etc.
- Iron and steel metallurgy: such as iron and steel, metallurgy, casting, etc.
- Aerospace: such as aircraft, rockets, etc.

Parameters Table

Range	0-20T	Material quality	Alloy Steel
Output sensitivity	2.0mV/V	Impedance	350Ω
Zero point output	±1%F.S.	Insulation resistance	≥5000MΩ/100VDC
Nolinear	0.05%F.S.	Service voltage	5-15V
Hysteresis	0.05%F.S.	Operating temperature range	-20-80°C
Repeatability	0.03%F.S.	Safe overload	150%
Creep (30 min)	0.05%F.S.	Extreme overload	200%
Temperature sensitivity drift	0.05%F.S./10°C	Cable line specifications	Φ5 <2T 3m >2T 5m
Xero point temperature drift	0.05%F.S./10°C	Cable limit tension	10kg
Response frequency	10kHz	TEDS	Selectable

Range	ΦA	B	ΦC	D	E	M
0-1000kg	44	88	28	56	26	M16x1.5
1-5T	58	112	38	68	44	M24x3
10T	84	160	60	104	58	M36x4
20T	88	156	68.5	108	76	M36x4